

2.5 x 9.75/SQU DIP

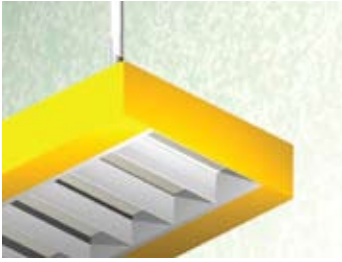

Lighting: Direct/Indirect
Mounting: Pendant or Cable
Length: Stocked up to 8'
Connectors: Consult Factory For Details
Diffuser: Parabolic Aluminum Louver
Finish: Mill Finish
Options: Consult Factory

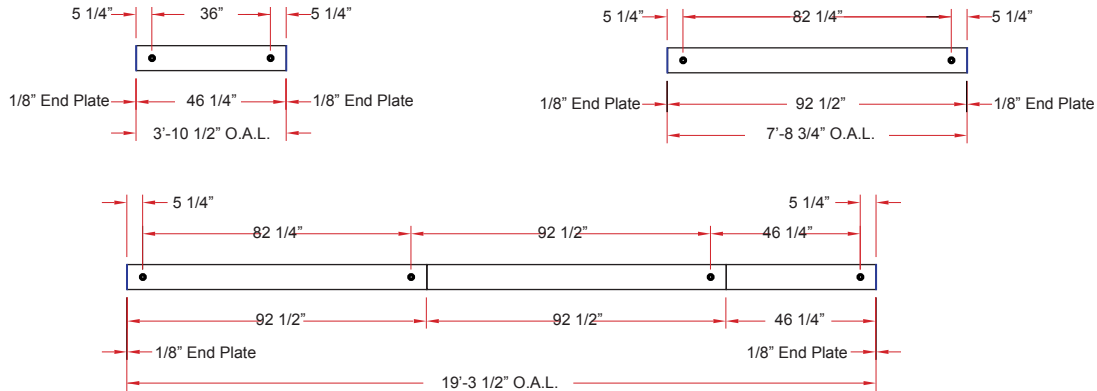
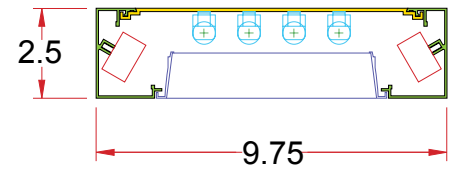

2.5 x 9.75/SQU DS

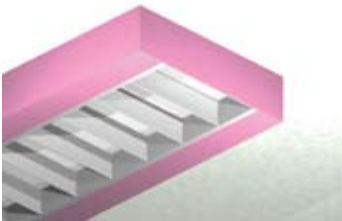

Lighting: Indirect
Mounting: Pendant or Cable
Length: Stocked up to 8'
Connectors: Consult Factory For Details
Diffuser: None
Finish: Mill Finish
Options: Consult Factory

