

# 2.5 x 6.75/SQU DP

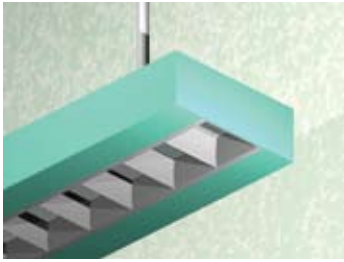

**Lighting:** Direct  
**Mounting:** Pendant or Cable  
**Length:** Stocked up to 8'  
**Connectors:** Consult Factory For Details  
**Diffuser:** Parabolic Aluminum Louver  
**Finish:** Mill Finish  
**Options:** Consult Factory

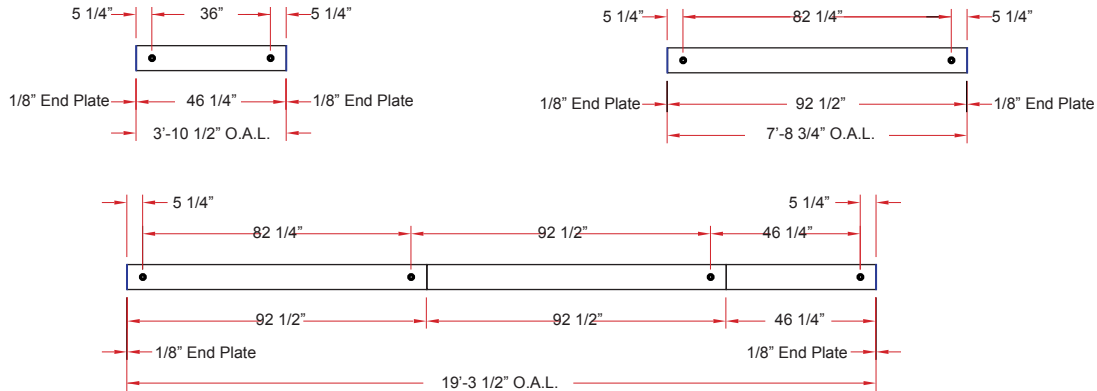
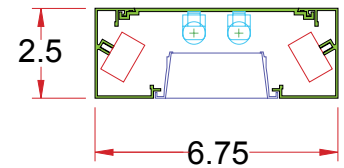

# 2.5 x 6.75/SQU IP

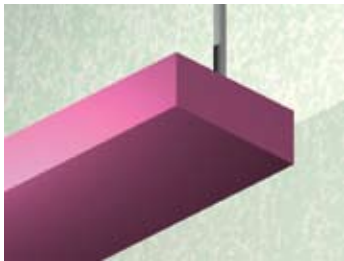

**Lighting:** Indirect  
**Mounting:** Pendant or Cable  
**Length:** Stocked up to 8'  
**Connectors:** Consult Factory For Details  
**Diffuser:** None  
**Finish:** Mill Finish  
**Options:** Consult Factory

