

3.5 x 9/OVL DS (for Lens)

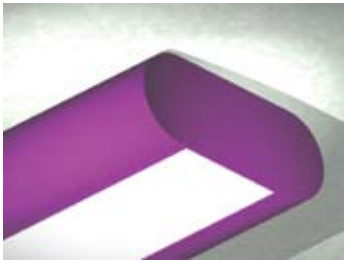

Lighting: Direct
Mounting: Surface
Length: Stocked up to 8'
Connectors: Consult Factory For Details
Diffuser: Prismatic Acrylic Lens by others
Finish: Sand Finish
Options: Consult Factory

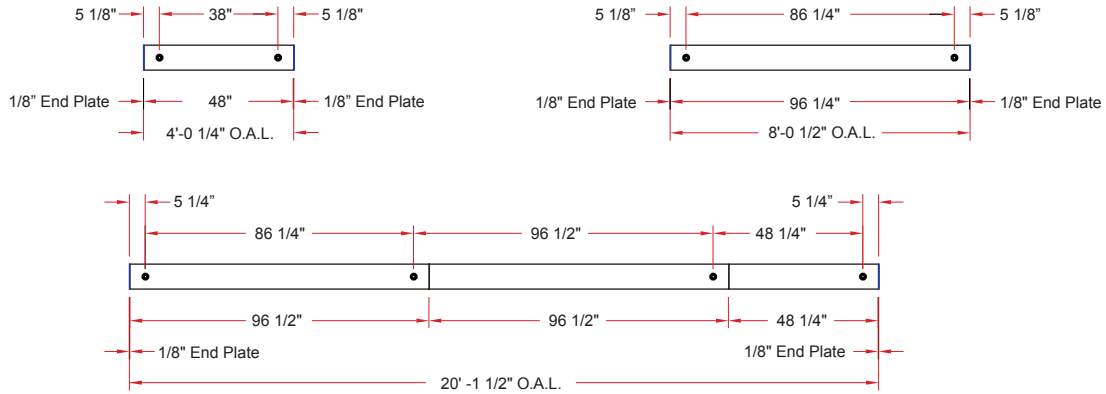
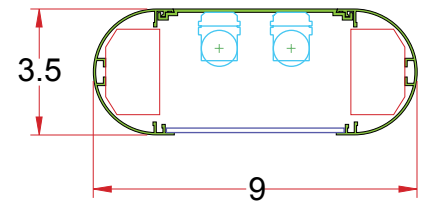

3.5 x 9/OVL 180°A IP

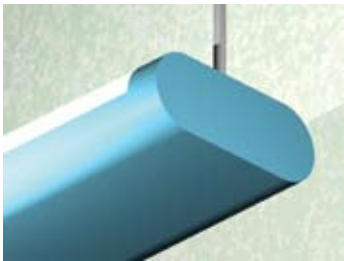

Lighting: Indirect
Mounting: Pendant or Cable
Length: Stocked up to 8'
Connectors: Consult Factory For Details
Diffuser: DR Acrylic Lens
Finish: Sand Finish
Options: Consult Factory

